

EROSION CONTROL PLAN

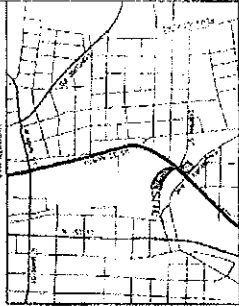

SITE SUMMARY:
 The purpose of this project is to construct a commercial building with associated parking area on the site. The site is located on the east side of U.S. 52 North, between U.S. 103 East and U.S. 104 East.

CONSTRUCTION SEQUENCE:
 1. SITE AND MAINT. A FIRE-RESISTION COVERED WITH 6" FILL.
 2. INSTALL THE FOLLOWING IMPROVEMENTS IN THE ORDER LISTED:
 - SITEWORK
 - FILL PROTECTION
 - EROSION CONTROL

1. EROSION CONTROL MEASURES SHALL BE INSTALLED PRIOR TO THE START OF CONSTRUCTION AND SHALL REMAIN IN PLACE THROUGHOUT THE CONSTRUCTION PERIOD.
 2. EROSION CONTROL MEASURES SHALL BE MAINTAINED AND REPAIRED AS NECESSARY.
 3. EROSION CONTROL MEASURES SHALL BE REMOVED UPON COMPLETION OF CONSTRUCTION AND THE SITE SHALL BE RESTORED TO ORIGINAL OR BETTER CONDITION.

EROSION CONTROL MEASURES:
 1. EROSION CONTROL MEASURES SHALL BE INSTALLED PRIOR TO THE START OF CONSTRUCTION AND SHALL REMAIN IN PLACE THROUGHOUT THE CONSTRUCTION PERIOD.
 2. EROSION CONTROL MEASURES SHALL BE MAINTAINED AND REPAIRED AS NECESSARY.
 3. EROSION CONTROL MEASURES SHALL BE REMOVED UPON COMPLETION OF CONSTRUCTION AND THE SITE SHALL BE RESTORED TO ORIGINAL OR BETTER CONDITION.

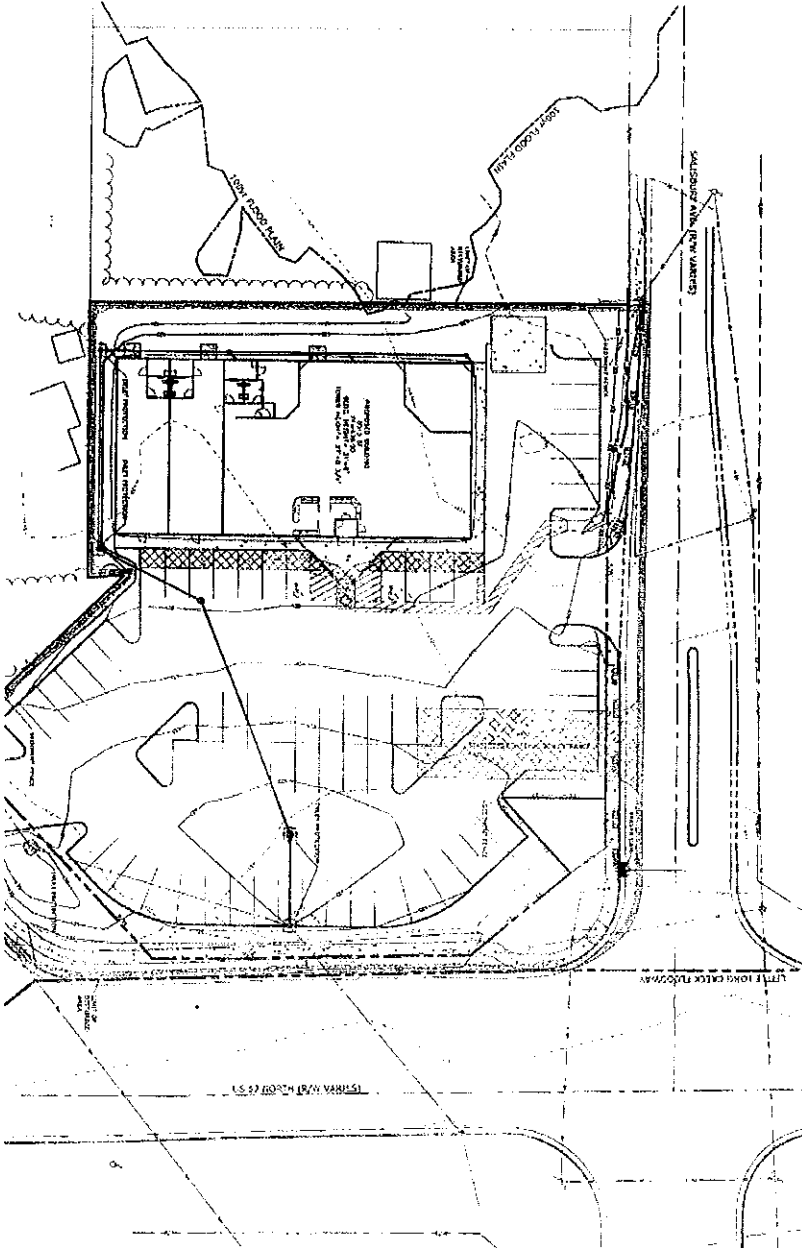

	Van Horn Hoover ENGINEERS 100 S. 10th Street Charlotte, NC 28202 (704) 354-7000
	P.O. BOX 648314 CHARLOTTE, NC 28262 (704) 354-7000
PROJECT NO. 02-1750L DATE: 02/15/02	CLIENT:
PROJECT:	ADDRESS:
SHEET NO.:	TOTAL SHEETS: