

QUANTITIES

NOTE: ALL QUANTITIES ARE APPROXIMATE AND MEANT FOR ESTIMATING PURPOSES ONLY

- 7500 SF SOD
- 500 YD BLACK DIRT
- 850 LF WHITE ACRYLIC LATEX TRAFFIC MARKING PAINT

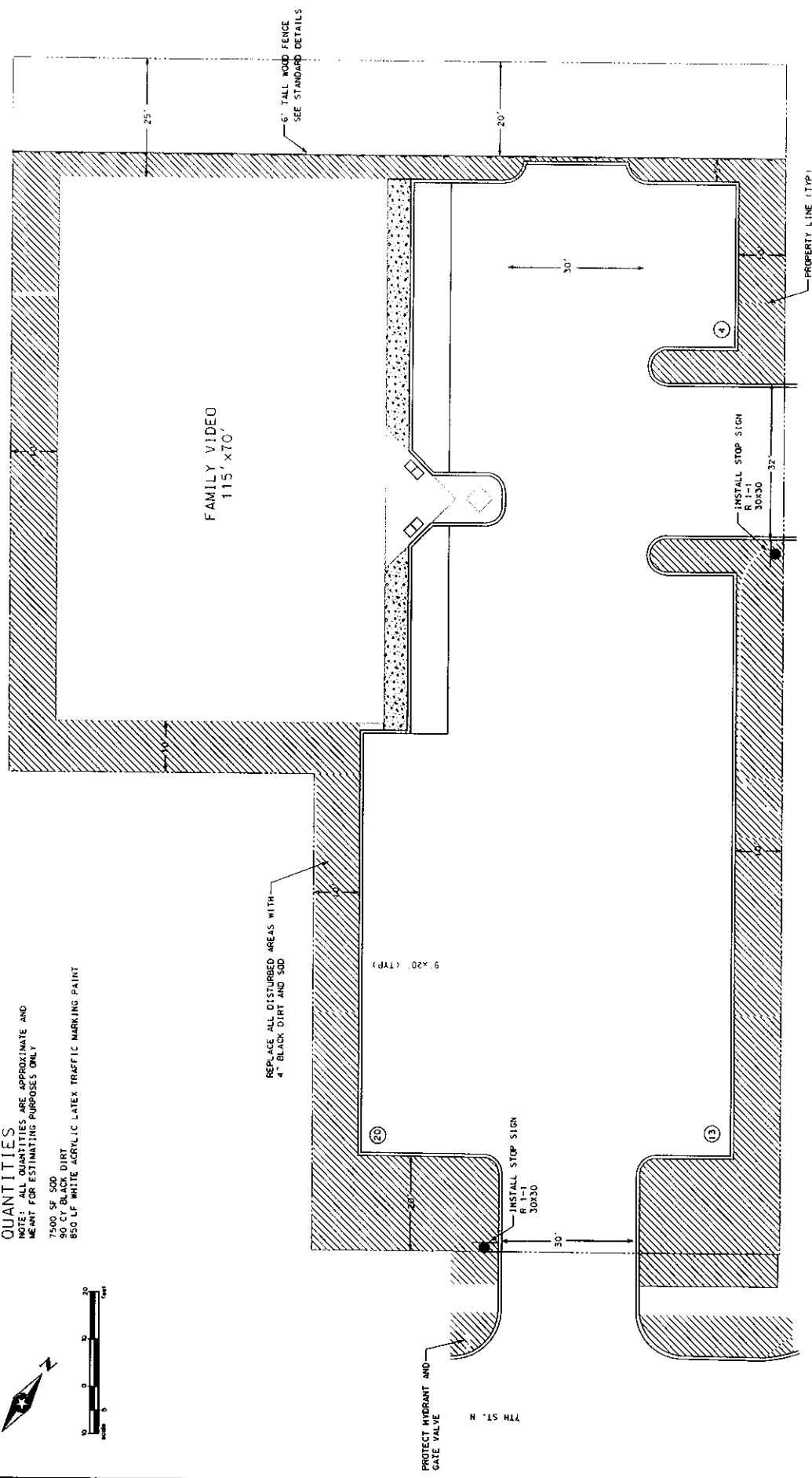
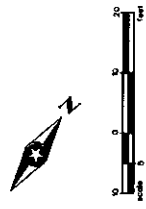

N BROADWAY ST. (T.M. 15)

DESIGNER: JMC	NO. 01	DATE	REVISIONS
CHECKED BY: JN			
APPROVED BY: JN			
DESIGN TEAM			

© SHORT ELLIOTT, MINNESOTA 2008. ANY USE OR REUSE OF THIS DRAWING WITHOUT THE WRITTEN PERMISSION OF SHORT ELLIOTT, MINNESOTA IS PROHIBITED. SEH SHALL NOT BE RESPONSIBLE FOR DAMAGES RESULTING FROM THE USE OF THIS DRAWING.

THESE QUANTITIES WERE PREPARED BY SHORT ELLIOTT, MINNESOTA, A PROFESSIONAL ENGINEER LICENSED IN THE STATE OF MINNESOTA. CONSULT YOUR CONTRACTOR FOR QUANTITIES OF THIS MATERIAL, OR CONTACT SEH FOR ASSISTANCE.

SEH
 4000 LED, ORCHARD DRIVE #200
 PH 952.932.2603 FAX 952.932.2600
 PH 800.734.9757

FAMILY VIDEO
 ROCKFORD CONSTRUCTION
 NEW ULM, MN

SIGNING, STRIPING, &
 LANDSCAPE PLAN

FILE NO. 5
 4-RFP DRAWING
 DATE 5/1/03