

Erie Avenue (50')

ONE WAY TRAFFIC →

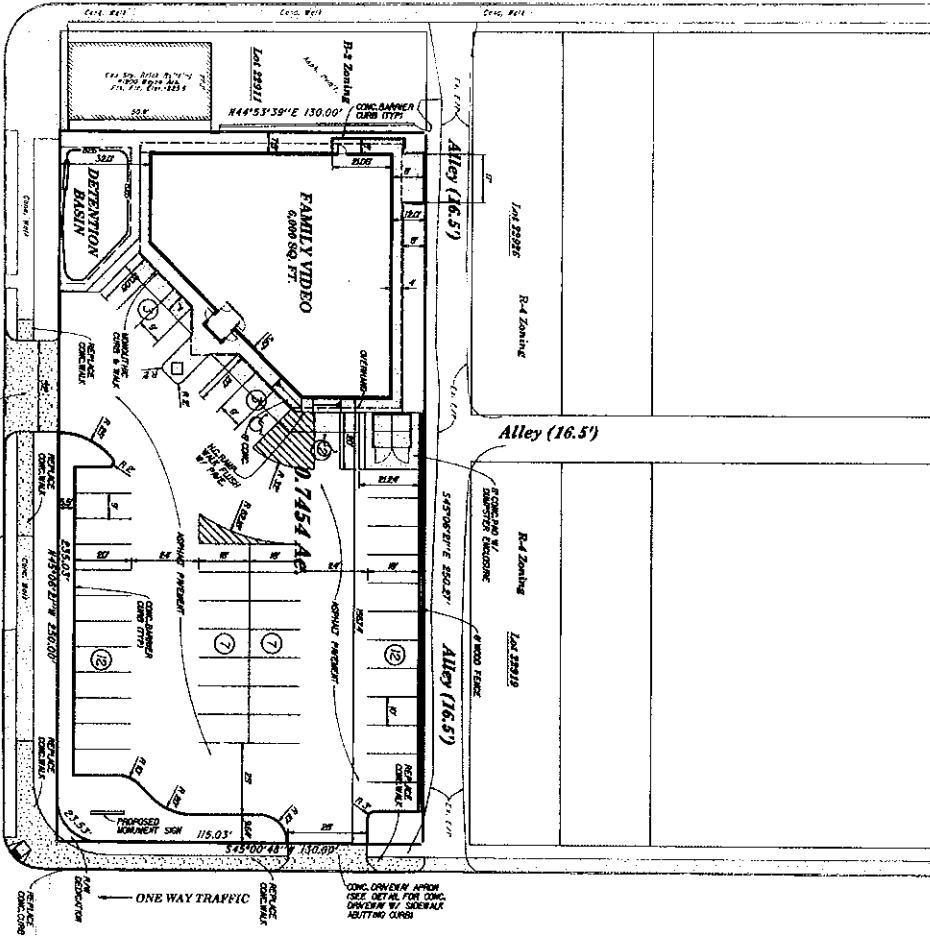

Medford Street (50')

Wayne Avenue (76')

Volkenand Street (50')

NOTES

1. The following information shall be used in conjunction with the zoning ordinance and subdivision map to determine the zoning classification of the property.
2. All zoning codes are subject to the provisions of the zoning ordinance and subdivision map.
3. The zoning classification of the property shall be determined by the zoning ordinance and subdivision map.
4. The zoning classification of the property shall be determined by the zoning ordinance and subdivision map.
5. The zoning classification of the property shall be determined by the zoning ordinance and subdivision map.
6. The zoning classification of the property shall be determined by the zoning ordinance and subdivision map.
7. The zoning classification of the property shall be determined by the zoning ordinance and subdivision map.
8. The zoning classification of the property shall be determined by the zoning ordinance and subdivision map.
9. The zoning classification of the property shall be determined by the zoning ordinance and subdivision map.
10. The zoning classification of the property shall be determined by the zoning ordinance and subdivision map.

ZONING DATA

Zone: B-2
 Minimum Front Yard: None Required
 Minimum Side Yard: None Required
 Minimum Rear Yard: None Required
 Minimum Lot Coverage: 20%
 Minimum Building Footprint: 100 SF
 Minimum Setback: 5' (Front, Side, Rear)
 4,800 SF/2,500 SF/2,500 SF/2,500 SF
 48 spaces provided include:
 2 Van Access (RV) spaces
 2 Van Access (RV) spaces
 Minimum Drive: 16' Width; Not Specified

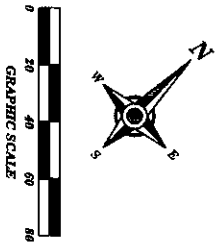

Site Plan
FAMILY VIDEO
 875441818 Wayne Avenue
 City of Dayton, Montgomery County, Ohio
 Andrew E. Tenny 2, Richard E. Tenny
 Date: 7-1-98
 Scale: 1" = 30'
 Title: Site Plan
 Author: Schaeffer, Amy H. Hovest, et al.
 Date: 7-1-98
 Scale: 1" = 30'
 Title: Site Plan
 Author: Schaeffer, Amy H. Hovest, et al.
 Date: 7-1-98
 Scale: 1" = 30'